

STATE OF NORTH CAROLINA
DEPARTMENT OF TRANSPORTATION
HIGHWAY DIVISION 6

PLANS

Let Date: October 6, 2021

CONTRACT ID: DF00290

TIP NO.: -----

FEDERAL AID NO.: STATE FUNDED

WBS ELEMENT NO.: 2022CPT.06.04.20242.1 & 2022CPT.06.04.20242.2

ROUTE NO.: VARIOUS SR

LOCATION: VARIOUS

COUNTY: COLUMBUS

TYPE OF WORK: ASPHALT SURFACE TREATMENT – DOUBLE & TRIPLE SEALS

LENGTH OF PROJECT: 23.784 MILES

**This electronic collection of documents is provided
for the convenience of the user
and is Not a Certified Document –**

**The documents contained herein were originally issued
and sealed by the individuals whose names and license
numbers appear on each page, on the dates appearing
with their signature on that page.**

**This file or an individual page
shall not be considered a certified document.**

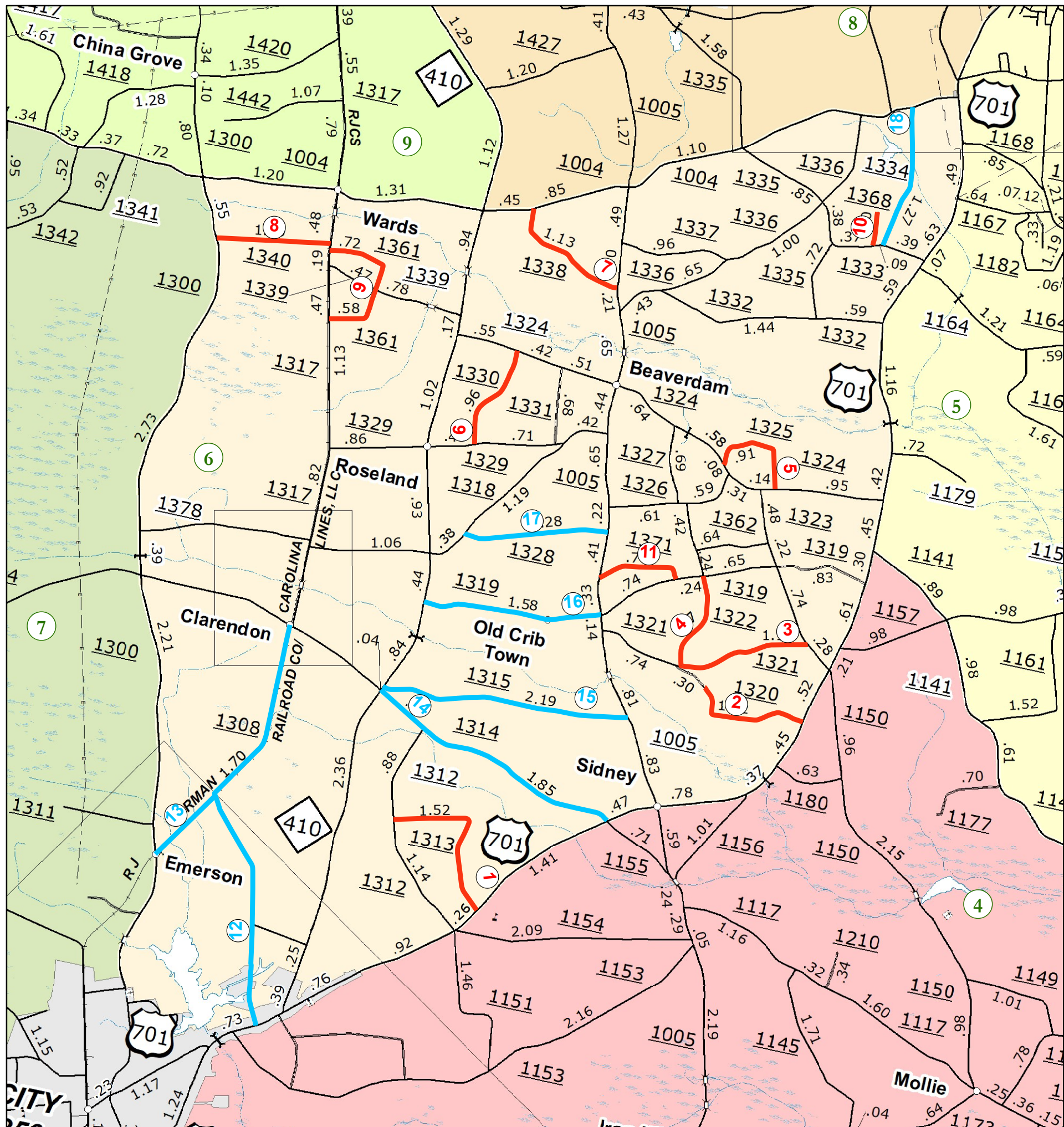

Date: 8/24/2021
 Contract #: DF00290
 WBS: Double Seals - 2022CPT.06.04.20242.1
 Triple Seals - 2022CPT.06.04.20242.2
 Division : 6
 County: Columbus
 Description: AST - Double & Triple Seals

Map	Route	From	Begin MP	To	End MP	CL Length (Mile)	Width (Ft.)	Yardage (SY)	Treatment	Emulsion (GAL)
1	SR 1313	SR 1312	0.000	US 701	1.520	1.520	19	18,637	Double	10,250
2	SR 1320	End PVMT	0.304	US 701	1.420	1.116	20	14,404	Double	7,922
3	SR 1321	SR 1322	0.780	SR 1323	1.940	1.160	19	14,223	Double	7,823
4	SR 1322	SR 1319	0.660	SR 1321	1.530	0.870	19	10,667	Double	5,867
5	SR 1325	SR 1324	0.000	SR 1324	0.910	0.910	18	10,571	Double	5,814
6	SR 1330	SR 1329	0.000	SR 1324	0.960	0.960	19	11,771	Double	6,474
7	SR 1338	SR 1005	0.000	SR 1004	1.130	1.130	18	13,126	Double	7,219
8	SR 1340	SR 1317	0.000	SR 1300	1.000	1.000	18	11,616	Double	6,389
9	SR 1361	SR 1317	0.000	SR 1317	1.300	1.300	18	15,101	Double	8,306
10	SR 1368	SR 1333	0.000	Dead End	0.300	0.300	18	3,485	Double	1,917
11	SR 1371	SR 1005	0.000	SR 1319	0.760	0.760	20	9,809	Double	5,395
SUBTOTALS - DOUBLE SEALS:						11.026		133,410		73,376
12	SR 1308	US 701	0.000	SR 1314	3.810	3.810	18	44,257	Triple	34,520
13	SR 1310	SR 1300	0.000	SR 1308	0.740	0.740	18	8,596	Triple	6,705
14	SR 1314	US 701	0.000	NC 410	2.350	2.350	18	27,298	Triple	21,292
15	SR 1315	NC 410	0.000	SR 1005	1.740	1.740	18	20,212	Triple	15,765
16	SR 1319	SR 1005	2.470	NC 410	4.038	1.568	19	19,226	Triple	14,996
17	SR 1328	SR 1318	0.000	SR 1005	1.280	1.280	19	15,695	Triple	12,242
18	SR 1334	SR 1333	0.000	SR 1004	1.270	1.270	20	16,391	Triple	12,785
SUBTOTALS - TRIPLE SEALS:						12.758		151,675		118,305
TOTALS:						23.784		285,085		191,681

Legend
 Double Seals
 Triple Seals

Schedule of Quantities

Date: 8/24/2021
 Contract #: DF00290
 WBS: Double Seals - 2022CPT.06.04.20242.1 (DF00290A)
 Triple Seals - 2022CPT.06.04.20242.2 (DF00290B)

Division : 6
 County: Columbus
 Description: AST - Double & Triple Seals

Map	Route	From	Begin MP	To	End MP	CL Length (Mile)	Width (Ft.)	Yardage (SY)	Treatment	Emulsion (GAL)	WZ Signs (SF)
1	SR 1313	SR 1312	0.000	US 701	1.520	1.520	19	18,637	Double	10,250	112
2	SR 1320	End PVMT	0.304	US 701	1.420	1.116	20	14,404	Double	7,922	112
3	SR 1321	SR 1322	0.780	SR 1323	1.940	1.160	19	14,223	Double	7,823	112
4	SR 1322	SR 1319	0.660	SR 1321	1.530	0.870	19	10,667	Double	5,867	112
5	SR 1325	SR 1324	0.000	SR 1324	0.910	0.910	18	10,571	Double	5,814	112
6	SR 1330	SR 1329	0.000	SR 1324	0.960	0.960	19	11,771	Double	6,474	112
7	SR 1338	SR 1005	0.000	SR 1004	1.130	1.130	18	13,126	Double	7,219	112
8	SR 1340	SR 1317	0.000	SR 1300	1.000	1.000	18	11,616	Double	6,389	112
9	SR 1361	SR 1317	0.000	SR 1317	1.300	1.300	18	15,101	Double	8,306	112
10	SR 1368	SR 1333	0.000	Dead End	0.300	0.300	18	3,485	Double	1,917	84
11	SR 1371	SR 1005	0.000	SR 1319	0.760	0.760	20	9,809	Double	5,395	112
SUBTOTALS - DOUBLE SEALS:						11.026		133,410		73,376	1,204
12	SR 1308	US 701	0.000	SR 1314	3.810	3.810	18	44,257	Triple	34,520	269
13	SR 1310	SR 1300	0.000	SR 1308	0.740	0.740	18	8,596	Triple	6,705	112
14	SR 1314	US 701	0.000	NC 410	2.350	2.350	18	27,298	Triple	21,292	188
15	SR 1315	NC 410	0.000	SR 1005	1.740	1.740	18	20,212	Triple	15,765	112
16	SR 1319	SR 1005	2.470	NC 410	4.038	1.568	19	19,226	Triple	14,996	112
17	SR 1328	SR 1318	0.000	SR 1005	1.280	1.280	19	15,695	Triple	12,242	112
18	SR 1334	SR 1333	0.000	SR 1004	1.270	1.270	20	16,391	Triple	12,785	112
SUBTOTALS - TRIPLE SEALS:						12.758		151,675		118,305	1,017
TOTALS:						23.784		285,085		191,681	2,221

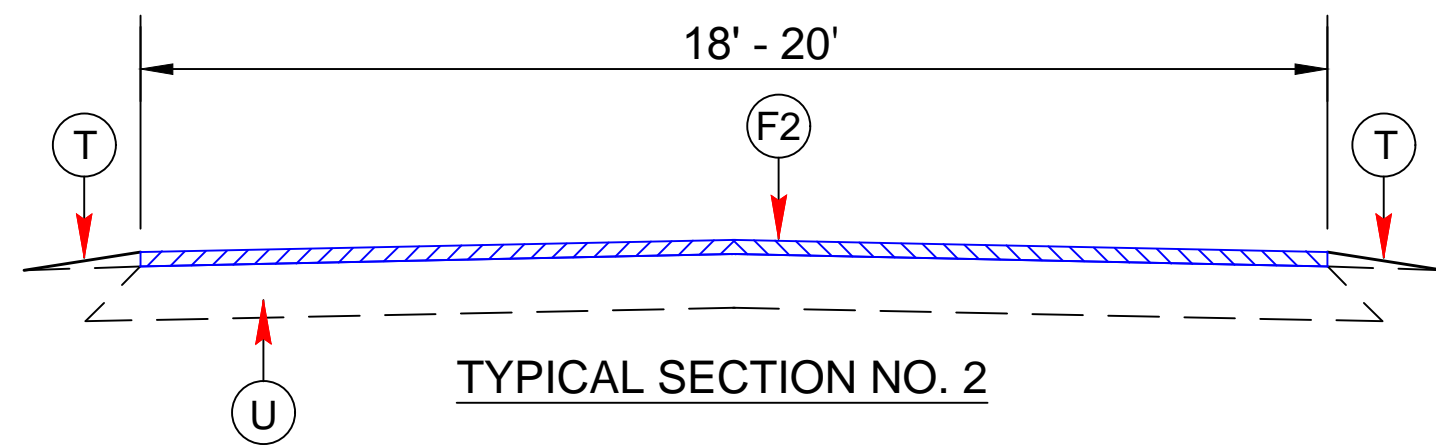
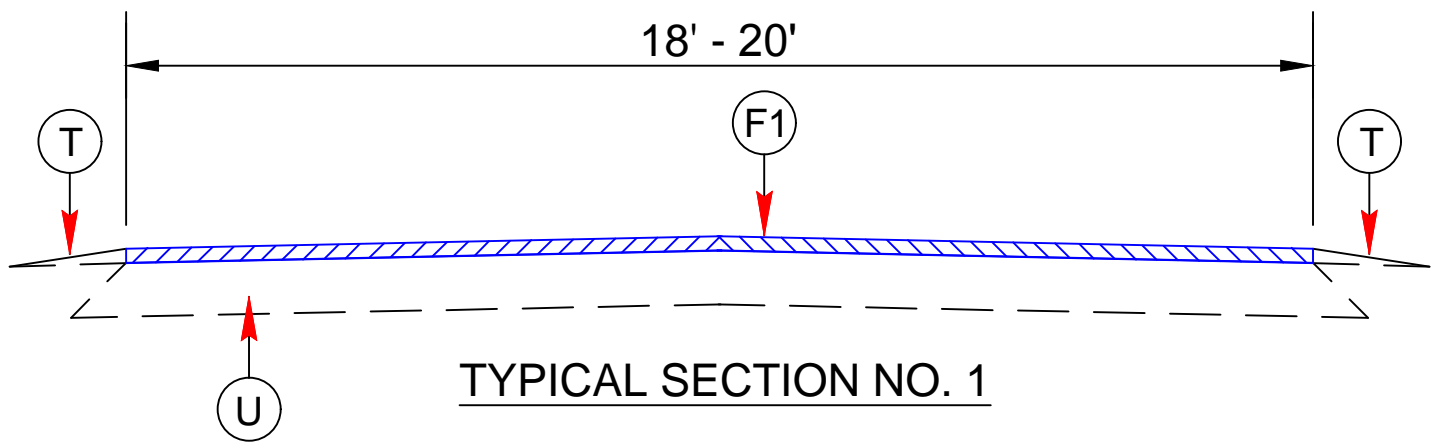

PAVEMENT SCHEDULE	
F1	DOUBLE SEAL PLACED ACCORDING TO THE SPECIAL PROVISIONS
F2	TRIPLE SEAL PLACED ACCORDING TO THE SPECIAL PROVISIONS
T	EXISTING SHOULDER
U	EXISTING ASPHALT

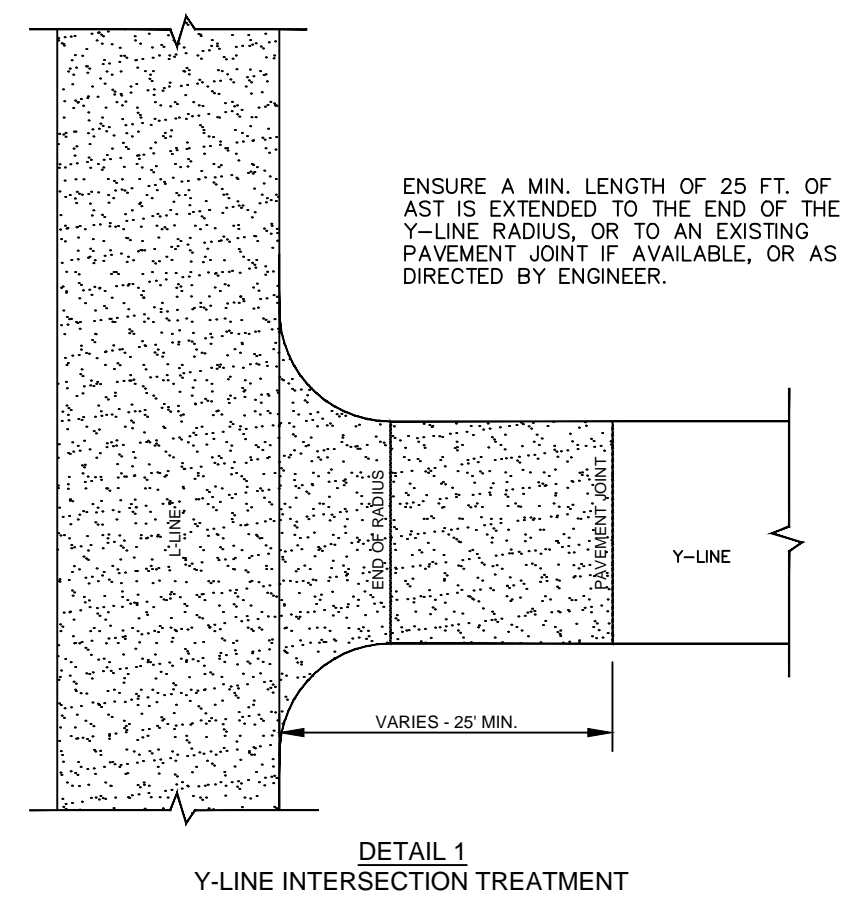

LEGEND	
	PORTABLE SIGN
	STATIONARY SIGN
	DIRECTION OF TRAFFIC FLOW

SIGNING FOR ASPHALT SURFACE TREATMENT

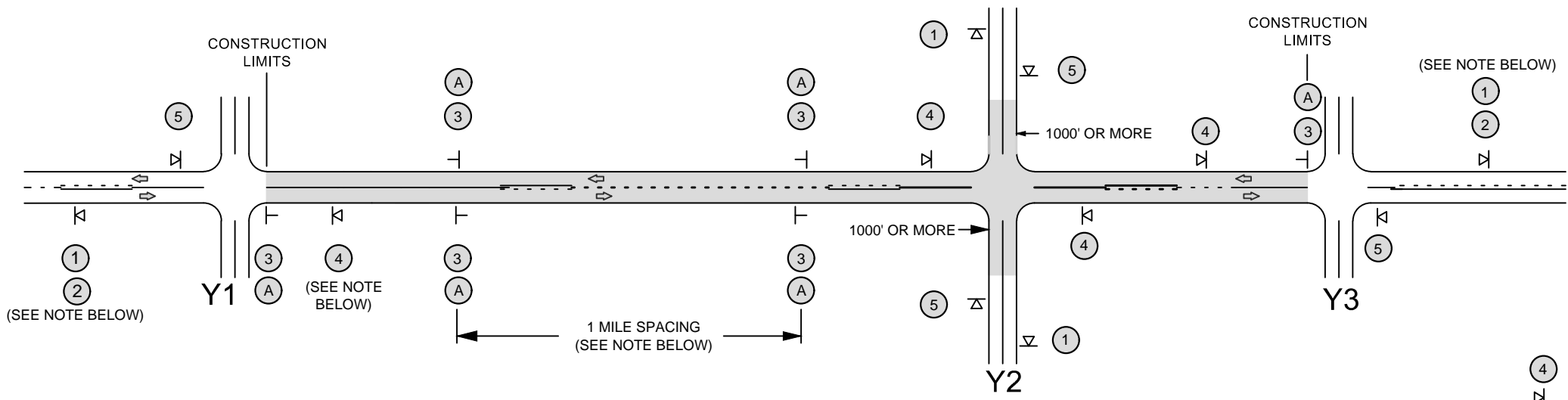

MAINLINE (-L-) SIGNING

-Y- LINE SIGNING

SIGNING NOTES AND PLACEMENT PER DIRECTION	①		- PLACE 1000' PRIOR TO BEGINNING OF CONSTRUCTION LIMITS. ONLY USED ON -Y- LINES IF RESURFACING LIMITS EXTEND 1000' ALONG -Y- LINE.
	②		- SIGN #2 ONLY USED WHEN RESURFACING LIMITS ARE 2 OR MORE MILES IN LENGTH. ROUND UP TO THE NEAREST WHOLE NUMBER. DO NOT USE FRACTIONAL OR DECIMAL NUMBERS.
	③		- ALTERNATE THE FOLLOWING TWO SIGNS: - STARTING WITH "LOOSE GRAVEL" (W8-7) FOLLOWED BY "UNMARKED PAVEMENT". - PLACE INITIALLY AT THE CONSTRUCTION LIMITS AND SPACED 1 MILE APART THEREAFTER.
			- AT TEE INTERSECTIONS INSTALL INITIALLY 0.5 MILE FROM INTERSECTION AND SPACE 1 MILE APART THEREAFTER.
	A		PLACE INITIALLY AT THE CONSTRUCTION LIMITS AND SPACED 1 MILE APART THEREAFTER. IF NO -Y- LINES EXIST, PLACE 2ND SET 1/2 MILE FROM THE CONSTRUCTION LIMITS AND THEN SPACE 1 MILE THEREAFTER. SPEED LIMIT SIGN MAY BE PLACED ON SAME POST AS LOOSE GRAVEL SIGN, IF DESIRED.
	④		- THESE ARE FOR -Y- LINES THAT ARE "THROUGH" ROADWAYS. DEAD END AND SUBDIVISION ROADS ARE NOT "THROUGH" ROADWAYS. - INSTALL 500' +/- FROM EACH -Y- LINE APPROACH AS SHOWN ABOVE. - FOR MULTIPLE -Y- LINES THAT ARE SEPARATED BY 0.25 MILES OR LESS, TREAT AS A SINGLE UNIT AND INSTALL WITHIN 500' OF EACH APPROACH. - A MAXIMUM OF 2 SIGN SETS PER MILE. DO NOT INSTALL WHEN -Y- LINES ARE WITHIN 0.5 MILES FROM "END ROAD WORK" SIGN.
⑤		PLACE 500' FOLLOWING THE END OF CONSTRUCTION LIMITS OR AS SHOWN WHEN WORK ENDS AT A 3-WAY TEE INTERSECTION.	

STATIONARY SIGNING NOT REQUIRED FOR THE FOLLOWING -Y- LINE CONDITIONS:

- LESS THAN 1000' OF RESURFACING ALONG -Y- LINE
- SUBDIVISION ROADS
- DEAD END ROADS

WHEN PAVING/CONSTRUCTION ACTIVITIES PROCEED ACROSS AN UNSIGNED -Y- LINE, PORTABLE ADVANCE WARNING SIGNS SHALL BE USED ALONG THE -Y- LINE AS SHOWN BELOW. REMOVE UPON COMPLETION OF WORK.

PLACED 500' IN ADVANCE OF FLAGGER.

PLACED 250' IN ADVANCE OF FLAGGER.

NOTE:
IT IS THE CONTRACTOR'S RESPONSIBILITY TO ENSURE THE PROPER PLACEMENT AND LOCATION OF WORK ZONE SIGNING PER THE STANDARD DRAWING. NCDOT HAS THE RIGHT TO INSPECT THE PLANNED LOCATIONS AND REQUIRE ADJUSTMENT BY THE CONTRACTOR, AS NEEDED, OR AS DIRECTED BY THE ENGINEER.

MAPS LESS THAN 2 MILES
FOR AST RESURFACING MAPS WITH CONSTRUCTION LIMITS LESS THAN 2 MILES IN LENGTH, USE A STATIONARY "LOOSE GRAVEL" SIGN AT THE BEGINNING CONSTRUCTION LIMIT FOLLOWED BY AN "UNMARKED PAVEMENT" SIGN MIDWAY THROUGH AND AN "END ROAD WORK" SIGN AT THE END CONSTRUCTION LIMIT.

REVISED - 12-13-2018

NCDOT - DIVISION 6

ADVANCE WARNING SIGNS FOR 2-LANE ROADWAY ASPHALT SURFACE TREATMENT

